



The Bishop`s Castle Railway Society Newsletter

March / April 2024



*Happy Easter
to all
our members*

REMINDER

All members will have already received notification by email or post

Notice of Annual General Meeting

The 2024 Annual General Meeting of the Bishop`s Castle Railway Society will be held at The Old Weighbridge, Station Street, Bishop`s Castle, SY9 5AQ at 2pm on Friday 19th April 2024.

All Members are entitled to attend and vote on the appointment of Director/Trustees. In line with the Articles of Association two of our current Directors are required to stand down this year, but can be re-appointed if they wish and members vote to do so. In addition, new Directors can be appointed. We need a minimum of three Directors, but there is no maximum. We currently have five. Directors are also Trustees as the Society is a Registered Charity and a Limited Company.

You will receive a voting form shortly after nominations close on 3rd April 2024. If you are unable to attend the meeting please return your voting form and any questions you would like ask, to Mike Boyd: thesecretary.bcr@gmail.com or post to The Old Weighbridge, Station Street, Bishop`s Castle, SY9 5AQ .

We look forward to seeing many of you on April 19th.

www.bcrailway.co.uk



[Bishop's Castle Railway Society | Facebook](#)

Weighbridge Railway Museum



The view of the sheds from the Weighbridge in April 2023

After 2 years of Ransfords waiting for planning permission to be granted, it took just a few days to demolish the sheds and clear the site opposite the Weighbridge.



The same view in March 2024

We expect some disruption over the coming months, but will endeavour to continue opening the museum on the 2nd and 4th Tuesday each month as usual.

Join us to watch the progression from derelict sheds and waste ground into a Co-op supermarket.

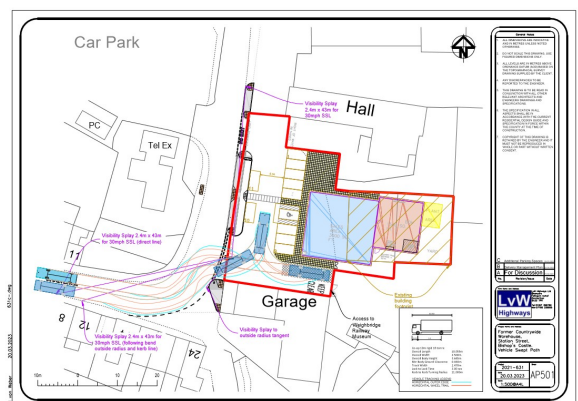



**GREETINGS CARDS from original
Bishop`s Castle Railway paintings
by Keith Noble**

£2.50 each

**in the Weighbridge Railway Museum
Or order from the website for just an
additional £1 postage for up to 3 cards**



The success of the cover print on the Winter Journal Issue 123 prompted James Sherratt from Craven Design and Print to suggest that it, or similar prints, would make a nice greetings card. He asked me if I knew any local artists.

As it happens Keith Noble, the artist responsible for the original painting of that cover print, lives just a couple of miles outside Bishop`s Castle. I knew he had painted a few scenes of the Bishop`s Castle Railway, two of them had been on display in the School Lane Museum until it closed in 2017. So I contacted Keith and after a long telephone discussion he arrived at the Weighbridge the following week with small copies of nine of his original paintings, all of the originals having been sold. He told me that regardless of who had bought the original paintings, copyright always remained with the artist, not the purchaser of the original painting. He then granted the society permission to produce all nine prints as greetings cards and did not wish to take any commission, donating the total profit from sales to the society funds.

I took the small prints to James Sherratt to see if he could use them and was delighted a few days later when he produced the lovely cards you see above. All as blank greetings cards and some with Happy Birthday on the front.

The two on the right have been held back because they will make excellent Christmas Cards later in the year.

Lin Dalton



This talk may be of interest to members.....

The Bishop`s Castle Railway would have joined the railway near Montgomery, if it had gone ahead, near to where the crash happened.

Sarn Local History Group

**A talk on the Abermule Train Disaster in 1921
Tuesday 23 May 7.30pm At the Village Hall, Sarn.**



The Abermule train collision was a head-on collision which occurred at Abermule, Montgomeryshire, Wales on Wednesday 26 January 1921, killing 17 people. The crash arose from misunderstandings between staff which effectively over-rode the safe operation of the Electric Train Tablet system protecting the single line.

Jim`s selection of videos.....

I deleted many links due to the adverts on YouTube when using Chrome. Here`s one though which is fine when run using Microsoft Edge.

It argues that everyone can have a railway layout so stop making excuses. Running time 12:05

<https://www.youtube.com/watch?v=HLaqJEwM3HU>

This is a link to a video that I`ve posted before showing a train stuck in the snow. Transport can be disrupted with just a little snow these days but it could be much worse in 1955

[Watch Snowdrift at Bleath Gill online - BFI Player](#)

This featured in the Shropshire Star about a new train concept being tested at the former site of Ironbridge Power Station

<https://www.shropshirestar.com/news/local-hubs/telford/ironbridge/2024/03/02/the-secret-train-being-tested-in-shropshire-that-could-revolutionise-rural-rail-journeys/>

The Officers of the Society

PRESIDENT : Keith Lucas

SECRETARY : Mike Boyd c/o The Old Weighbridge, Station Street, Bishop`s Castle, SY9 5AQ.
07778 309894 thesecretary.bcr@gmail.com

MEMBERSHIP SECRETARY : Lin Dalton 37 Mary Elizabeth Road, Ludlow, Shrops, SY8 1LP.
07553 010196 mail@ludfordpark.plus.com

TREASURER : Jill Thornton

SOCIETY ARCHIVIST : Jonathan Moor

SOCIAL MEDIA (WEBSITE/ FACEBOOK/ NEWSLETTER) : Lin Dalton mail@ludfordpark.plus.com

DIRECTOR/ TRUSTEES : Mike Boyd, Lin Dalton, Roger Dalton, David Hemsley, Richard Newcombe.

JOURNAL EDITOR : Peter Broxholme, 16 Park View Road, Wollescote, Stourbridge, DY9 8XD.
01384 896218 pjb.bcr@btinternet.com

You can opt out of receiving this newsletter at any time by emailing:- mail@ludfordpark.plus.com